

Installation Manual

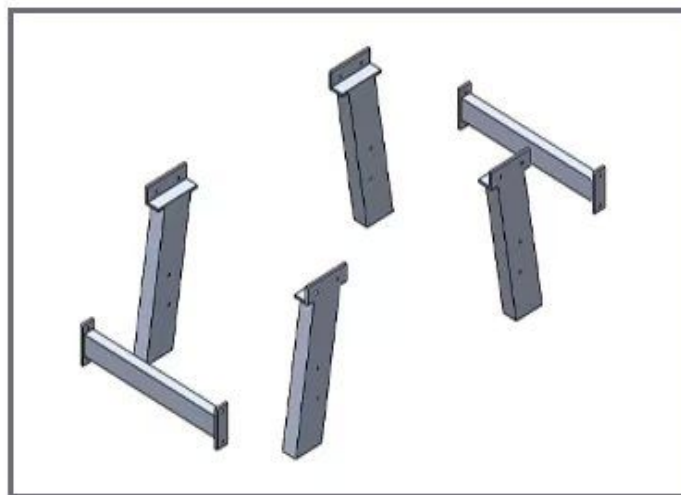

Step 1: Use 4 screws to fix the crossbar onto the 2 iron legs

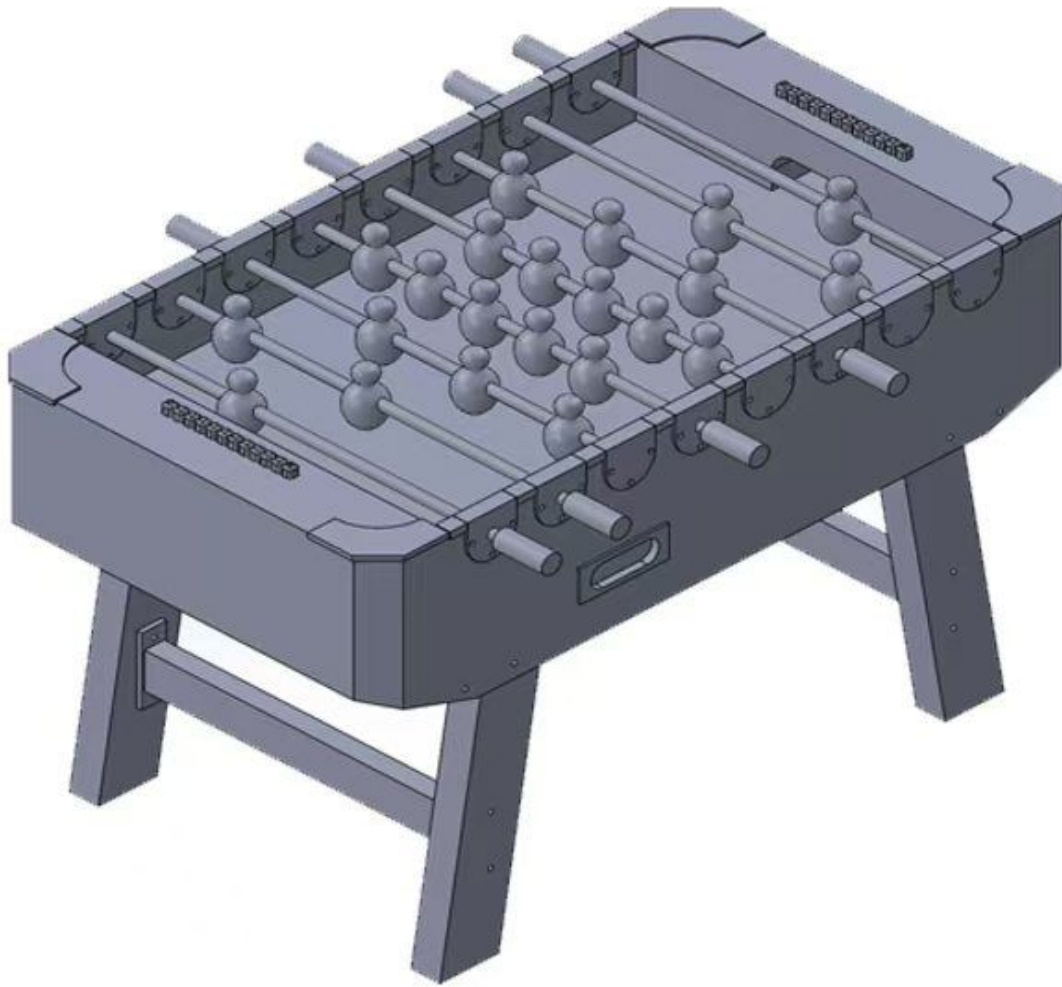
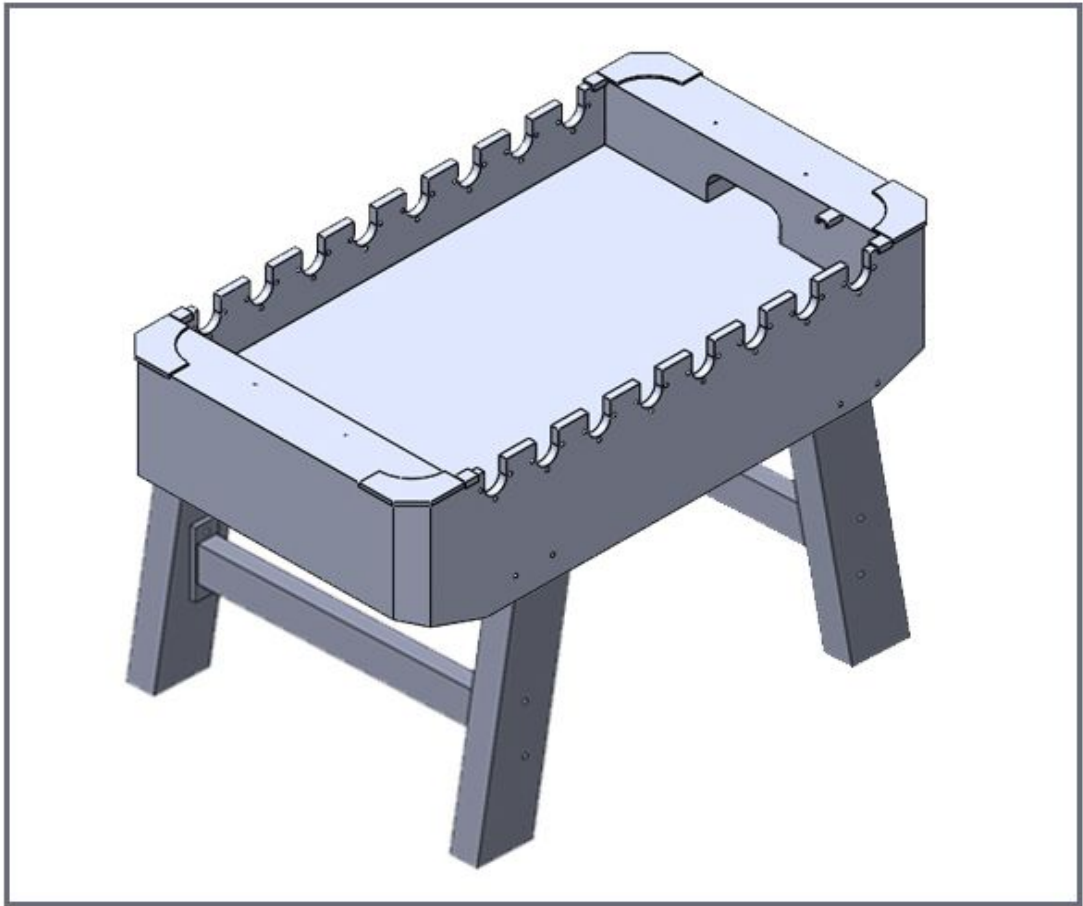

Step 2: Fix the iron legs onto the table frame with 8 screws

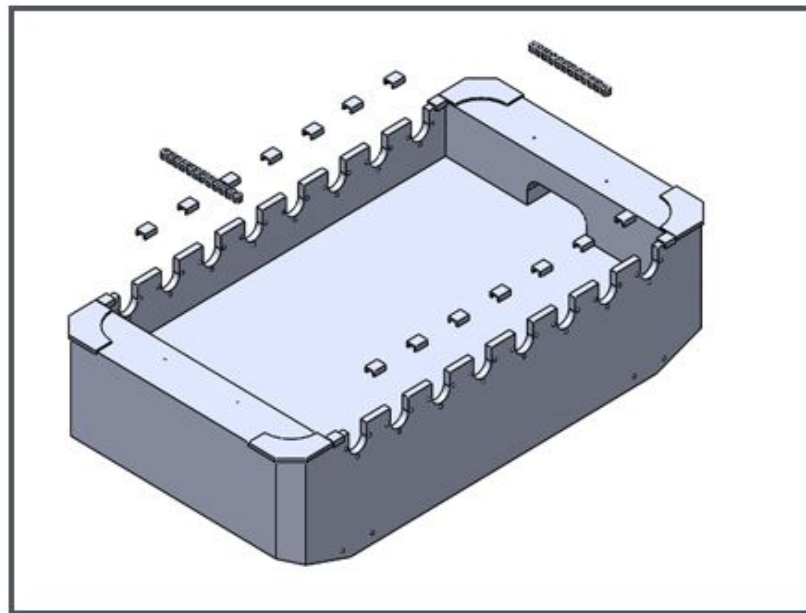

Step 3: Attach 14 plastic U-cards to the edge of the table and install the scorer

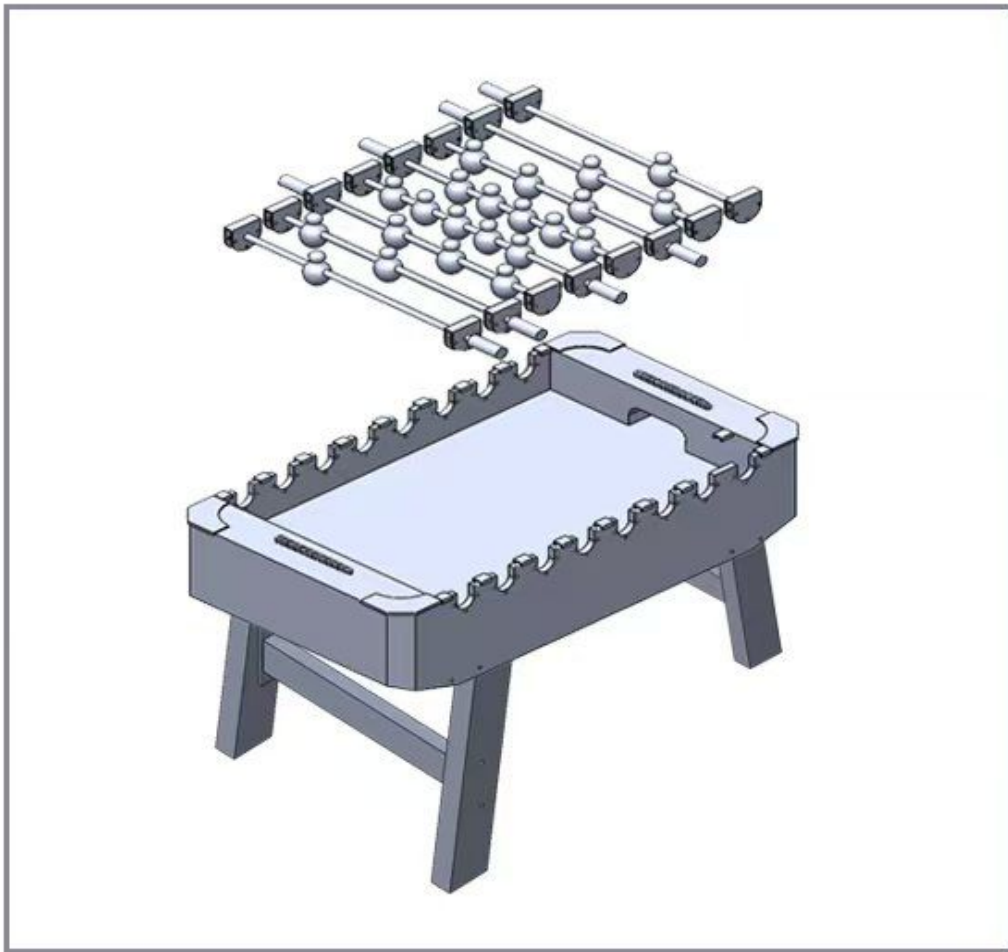

Step 4: Pass the 8 rods through the U-card, clip them into the U-slot of the table, and fix them with screws

Congratulations, you have completed the installation